



You can hear the difference!

Speaker Systems	Drivers	Kits	Multimedia	Company	Support	Purchase
-----------------	---------	------	------------	---------	---------	----------

F5 Bass-Midrange

light and extremely rigid cone made from Kevlar/paper composite;
 specially made high loss rubber surround;
 shielded double magnet motor structure;
 high power handling aluminum former voice coil;
 central phase plug;
 high-density aluminum die-cast basket.

The design of F5 has been optimized for an extended and dynamic bass reproduction in small vented systems as well as for midrange clarity and accuracy.

F5 utilizes a newly developed matrix of Kevlar and paper fibers. As a result, the cone weighs less, is more rigid and has an improved dampening factor over conventional Kevlar materials. The back of the cone is hand coated with a special dampening compound to further maximize performance stability and control of structural resonances. The driver utilizes a central phase plug to avoid air compression and internal air volume resonance. The plug improves frequency response and dispersion as well. The aluminum former voice coil and air transparent spider contributes to the linear operation of the transducer at high power levels.

The massive aluminum die-cast basket has been developed to minimize parasitic structural resonances.

A shielded magnet structure allows the F5 to be easily incorporated into audio/video applications. The driver may be incorporated in a small closed box as a bass-midrange unit, when a subwoofer is employed.

F5 has a remarkably smooth frequency response (within +/-2 dB tolerance in 120 - 5000 Hz range, measured in IEC baffle).

Recommended crossover frequency region for a two-way system design is 2 - 4 kHz.

Products Graph:

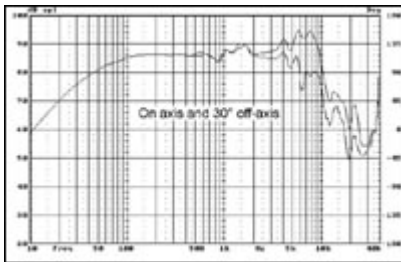

Frequency Response (Magnify)

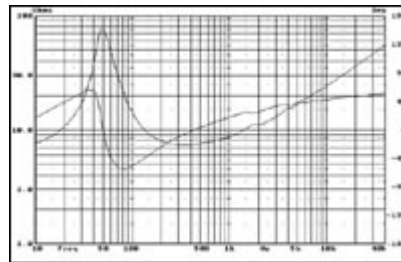

Impedance (Magnify)

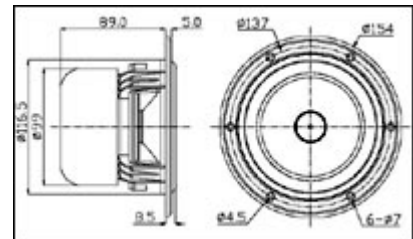

Mechanical Drawing (Magnify)

[More picture](#)

Woofer F series:

F5 Bass-Midrange

Nominal Impedance (Z)(O) :	8
Resonance Frequency (Fs)(Hz) :	52
Nominal Power Handling (Pnom)(W) :	35
Max Power Handling (Pmax)(W) :	70
Sensitivity (2.83v/1m)(dB) :	86



Weight (M)(Kg) :	1.6
VC Diameter (mm) :	25
DC (Re)(O) :	6.5
VC Length (H)(mm) :	10.4
VC Former :	CCAW
VC Frame :	Kapton
Magnet System :	Shielded
Magnet Former :	Ferrite
Force Factor (BL)(TM) :	8.3
Gap Height (He)(mm) :	5.0
Linear Excursion (Xmax)(mm) :	2.7
Suspension Compliance (Cms)(uM/N) :	828
Mechanical Q (Qms) :	4.31
Electrical Q (Qes) :	0.36
Total Q (Qts) :	0.33
Moving Mass (Mms)(g) :	11.5
Effective Piston Area (Sd)(m2) :	0.0079
Equivalent Air Volume (Vas)(L) :	7.3
Cabinet Type :	Vented
Recommended Box Volume(Vb)(L) :	8
Tuning Frequency(Fb)(Hz) :	50
-3dB Cut-Off Frequency(F3)(Hz) :	47