

L1 = 0,68 mH / Copper Wire 14 AWG / air core
 L2 = 0,67 mH / Copper Wire 20 AWG / air core

C1 = 35 MF / Polypropylene
 C2 = 2,7 MF / Polypropylene

R1 = 6,8 Ohm / 25 W
 R2 = 5,6 Ohm / Metal Oxide / 10 W

WO = Eton 7-200/A8/32 Hex
 TW = Eton 26HD1

Impedance Correction (optional)

Lx = 1,25 mH / Copper Wire 19 AWG / air core
 Cx = 6,8 MF / Polypropylene
 Rx = 27 Ohm / 10 W

ETON					Scale:	
LAUTSPRECHER-PRODUKTIONS-GMBH Pfaffenweg 21, D-89231 Neu-Ulm					Material:	
			Date	Name	Art. No. Madisound Eton S7 Bookshelf	
			Bearb. 19.10.09	Va		
			Gepr.			
			Norm		Zeichnung Nr. SK 1133	
						Page 1
						Bl.

Eton S7 Bookshelf

Technical Data

Sensitivity	89 dB
Impedance	8 Ohm
Recommended Amplifier Power	15 – 150 Watts
Tweeter	Eton 26HD1, Magnesium
Woofers	Eton 7-200/A8/32 Hex

Frequency response 1W / 1m

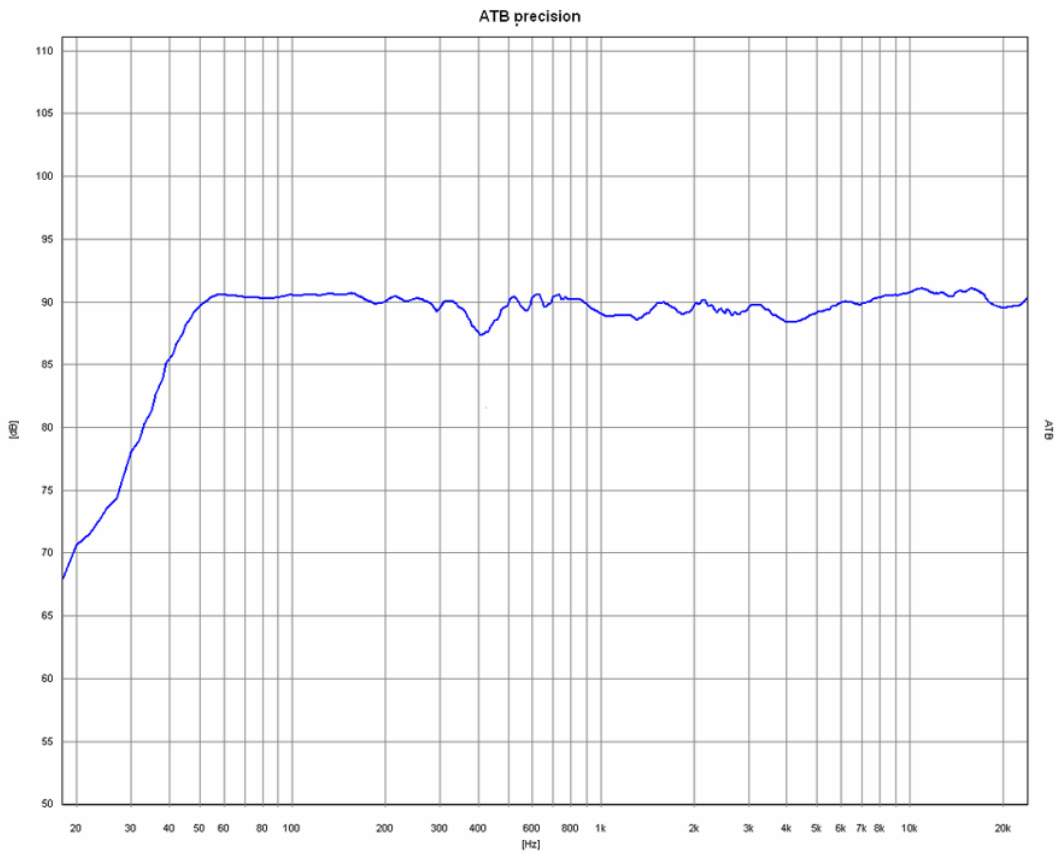

Crossover frequency

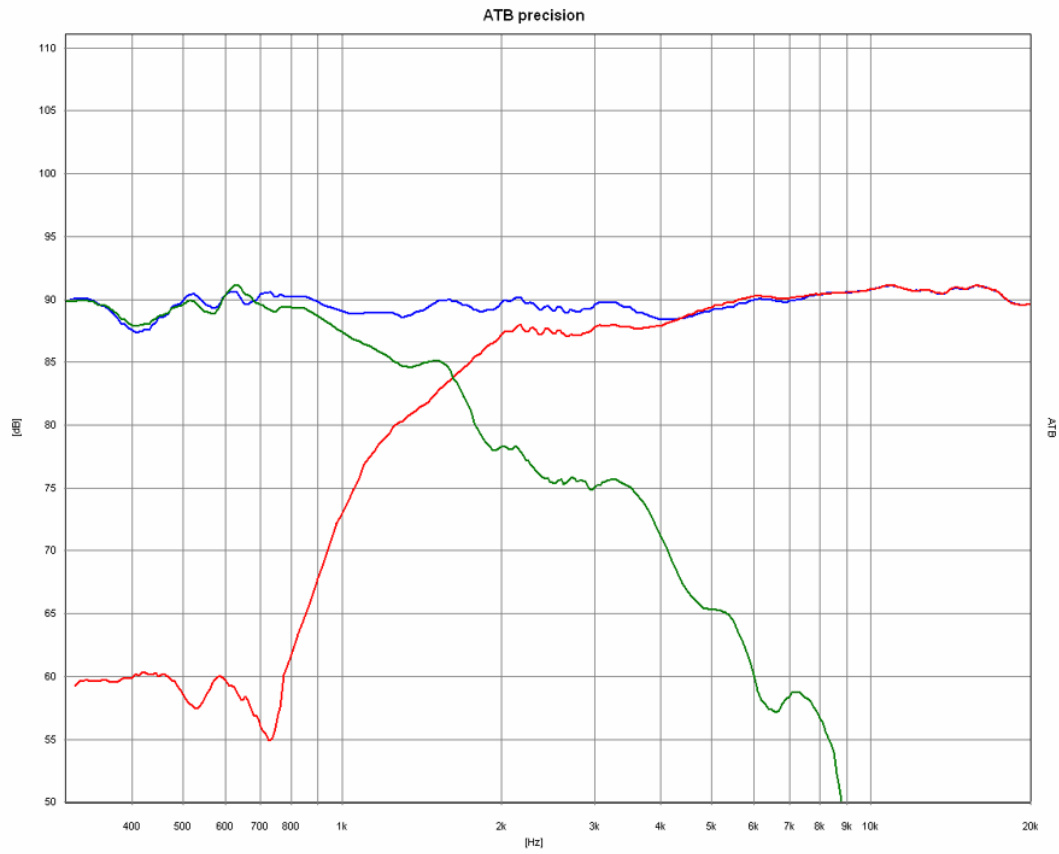

Angle 0,15,30,45°

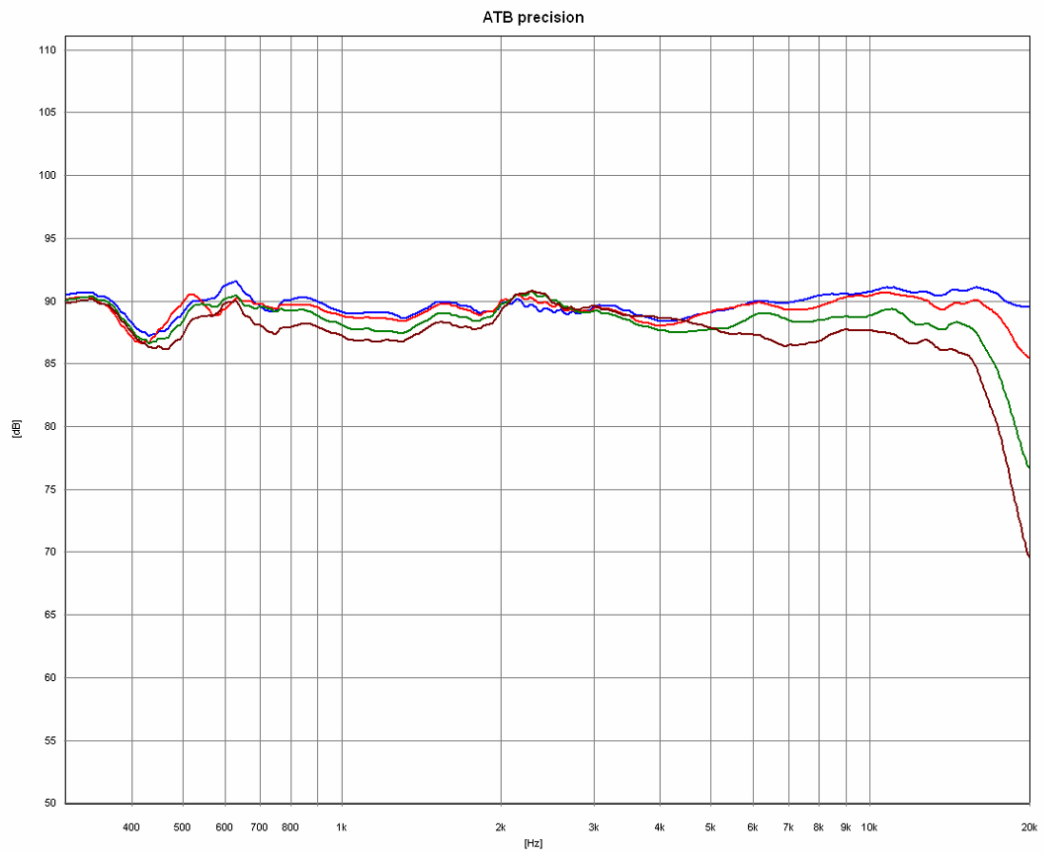

Impedance

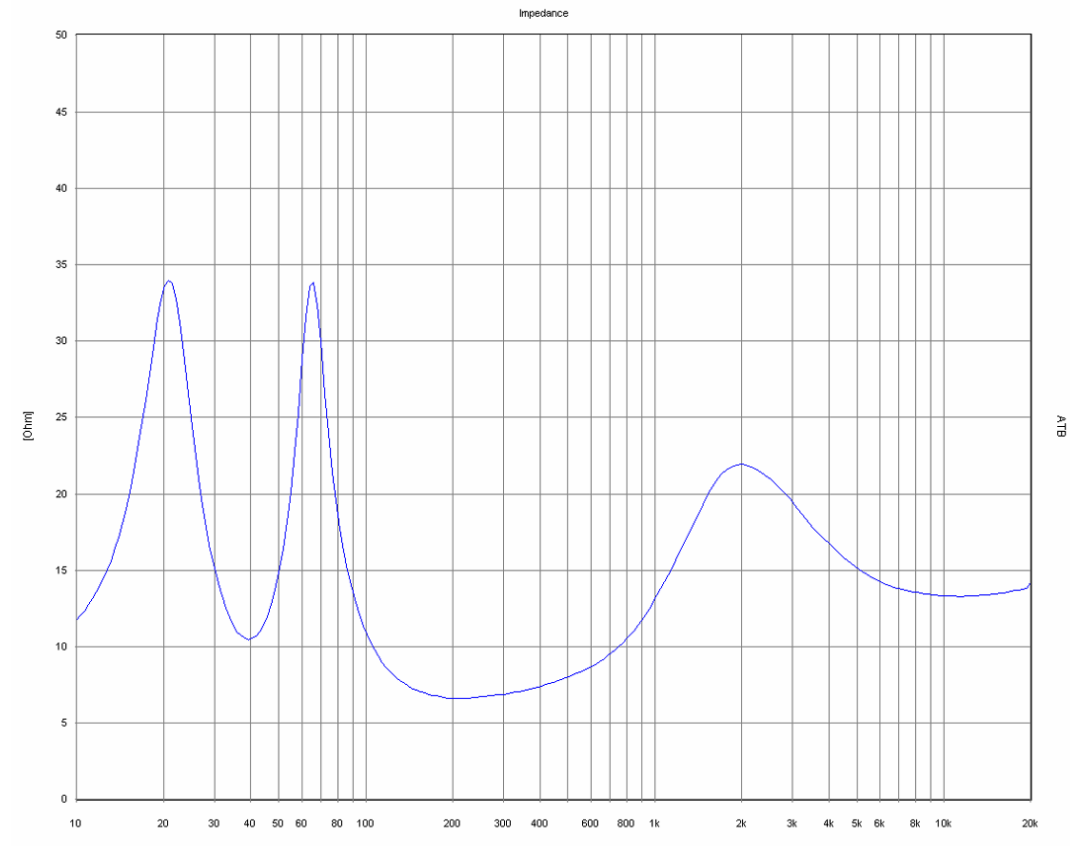

Distortion 1W

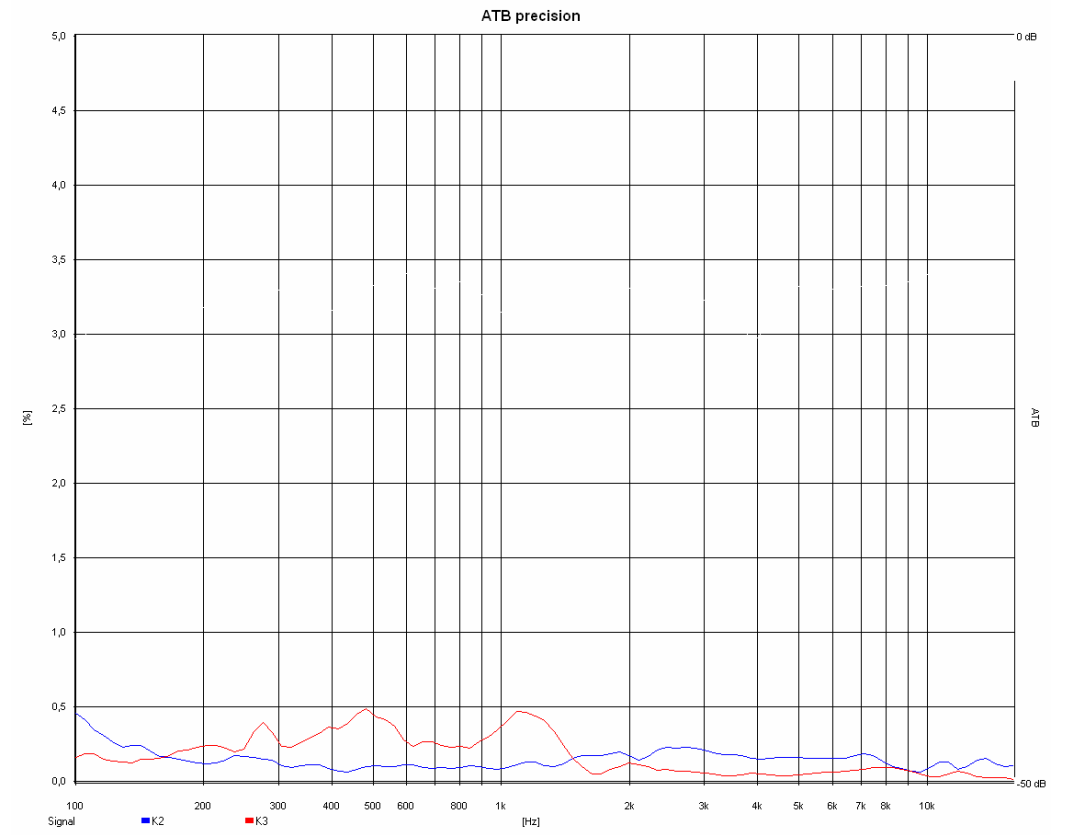

Waterfall

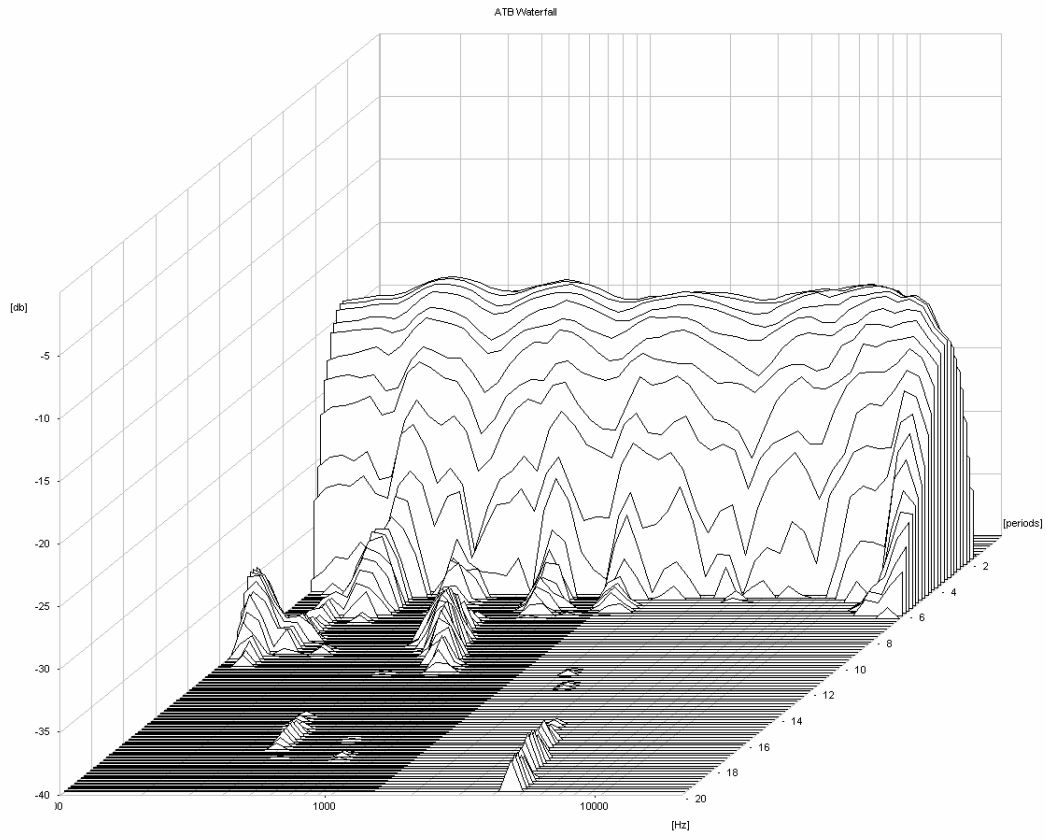

Madisound MD14 Cabinet

Dimensions [mm]

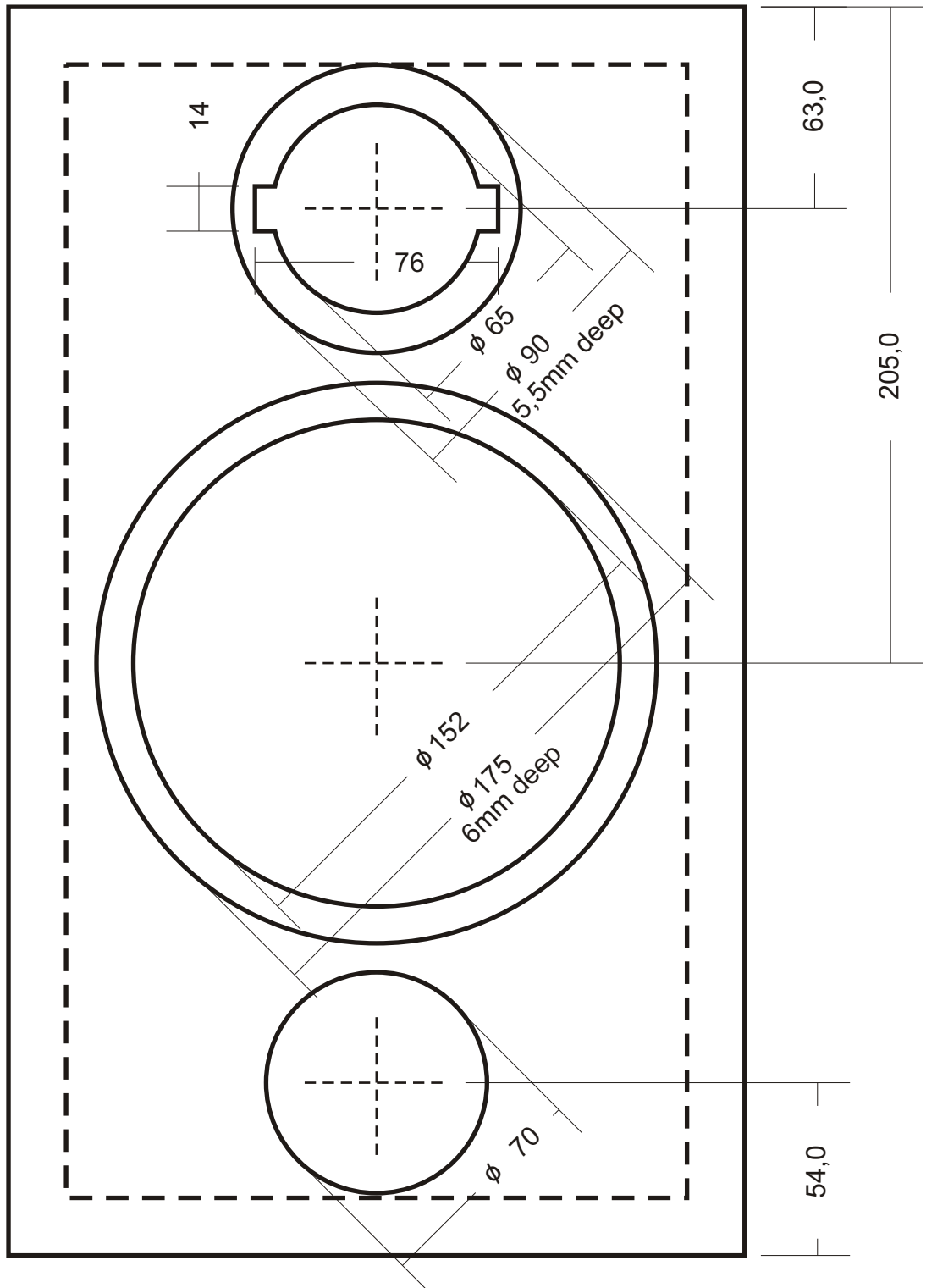

Madisound MD14 Cabinet

Damping = Polyester batting

Equivalent port tuning = Goldwood PT-306 port

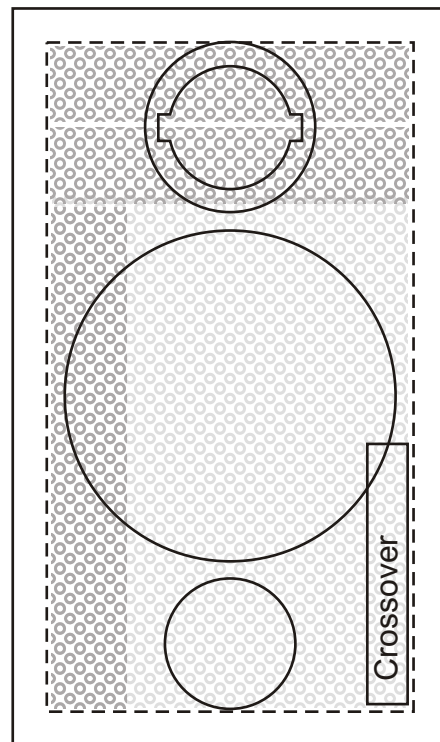
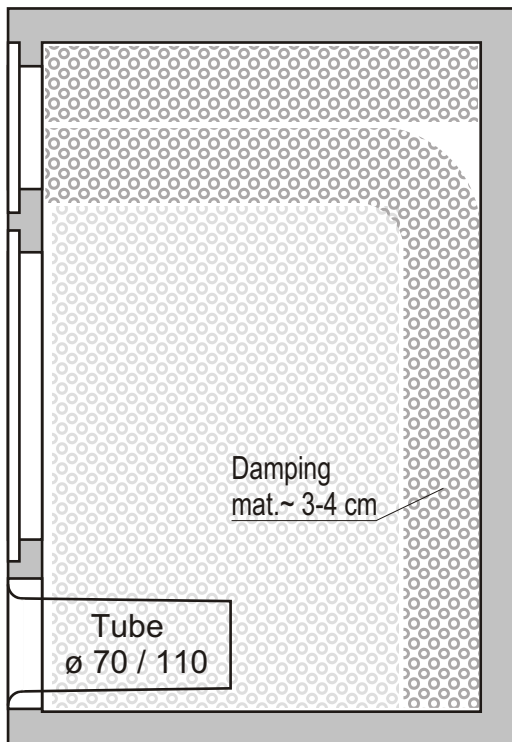

Madisound MD14 Cabinet Dimensions in mm
25.4mm = 1"

