

Peerless

ORDER ID

840100

AV 53 RD

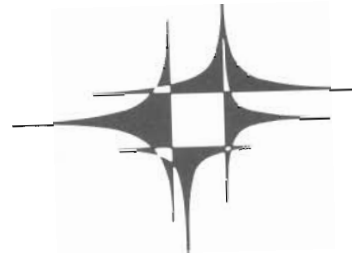

RINGDOME

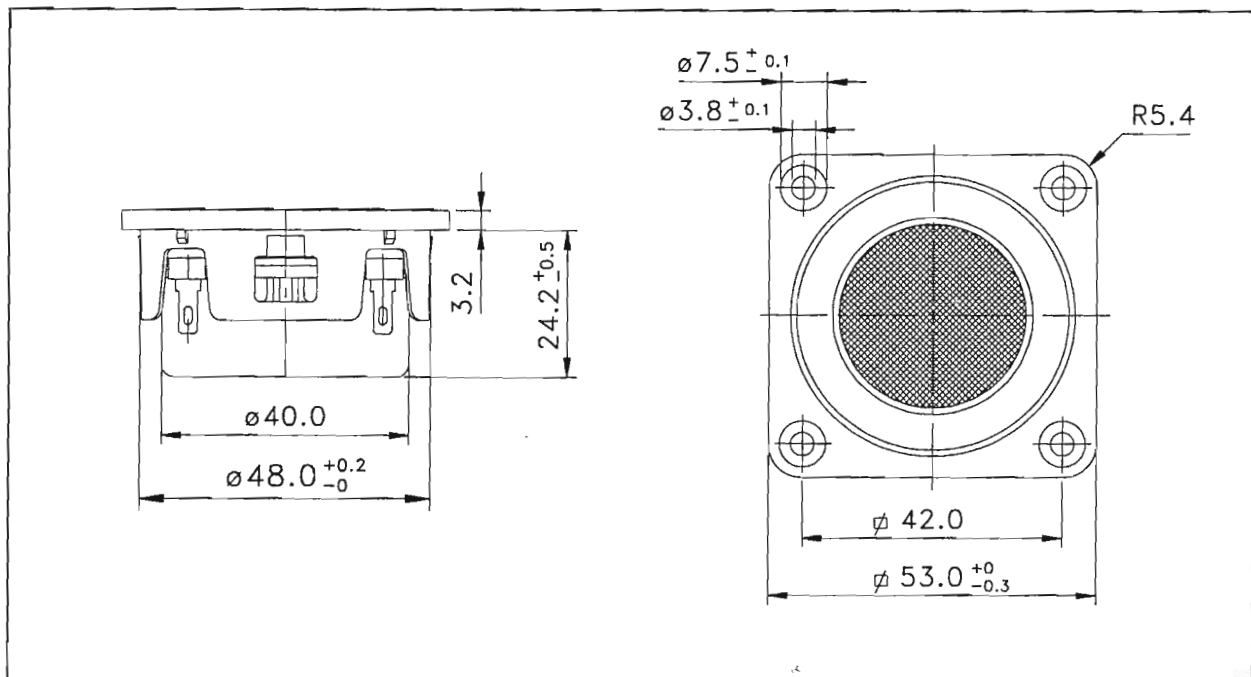

53 RD 13 32 LM FF CAN 8Ω

The AV Ringdome tweeter is a compact tweeter specially designed for home theater applications. The AV Ringdome tweeter uses a combined five layer aluminium and polymer cone to achieve a smooth and extended frequency response. The result is a more transparent sound than can normally be expected from compact hard dome tweeters. The AV Ringdome is supplied with protection grille for securing the dome. Ferrofluid provides high power handling and a smooth roll off in the low frequency area. Optimised dispersion with a flat on axis response for a more clear sound picture.

| FEATURE | ADVANTAGE | BENEFIT |
|---------------------------------------|---|---|
| Compact construction. | Easy to design in cabinet | Freedom in design of box. |
| Shielding with double magnet and can | Low magnetic stray field | Placement near TV or computer monitors which allows for many design options. |
| Customisation of front plate | Modify the speaker to a "personalised" look. | Strengthening the image on loudspeakers and loudspeaker manufacturer. Difficult to copy design. |
| Five layer aluminium and polymer cone | Smooth and extended frequency response | Transparent sound reproduction, especially compared to compact hard dome tweeters |
| Flat on axis frequency response | Optimised sound picture in front of centerchannel | Live and involving speech reproduction |

AV 53 RD



AV 53 RD

840100 53 RD 13 32 LM FF CAN 8Ω

Thiele Small parameters:

| | | |
|-----------------------------------|-----------------------|------------|
| Nominal impedance | Zn (Ω) | 8 |
| Minimum impedance/at freq. | Zmin (Ω/Hz) | 6.4 / 3500 |
| Maximum impedance | Zo (Ω) | 7.5 |
| Dc resistance | Re (Ω) | 6.0 |
| Voice coil inductance | Le (mH) | 0.1 |
| Resonance Frequency | fs (Hz) | 1400 |
| Mechanical Q factor | Qms | 1.18 |
| Electrical Q factor | Qes | 4.60 |
| Total Q factor | Qts | 0.94 |
| Mechanical resistance | Rms (Kg/s) | 1.18 |
| Moving mass | Mms (g) | 0.16 |
| Suspension compliance | Cms (mm/N) | 0.08 |
| Effective cone diameter | D (cm) | 2.6 |
| Effective piston area | Sd (cm ²) | 5.3 |
| Force factor | Bl (N/A) | 1.4 |
| Reference voltage sensitivity | (dB) | 88 |
| Re 2.83V 1m at 3500 Hz (Measured) | | |

Magnet and voice coil parameters:

| | | |
|---------------------|---------|---------|
| Voice coil diameter | d (mm) | 13 |
| Voice coil length | h (mm) | 1.8 |
| Voice coil layers | n | 2 |
| Flux density in gap | B (T) | 0.90 |
| Total useful flux | (mWb) | 0.1 |
| Height of the gap | hg (mm) | 2 |
| Diameter of magnet | dm (mm) | 40+32 |
| Height of magnet | hm (mm) | 7.5+5.5 |
| Weight of magnet | (kg) | .04+.02 |

PRELIMINARY
DATA

Power handling

Longterm Max System Power (IEC) (W) 100

A noise signal simulating normal programme material with a crest factor of 6dB (IEC 268-5) is used in Longterm Power and Lin. SPL tests.
Frequency range for test signal (HZ) 5000-20000

